

**Hydroflo Pumps USA, Inc.**  
7118 Loblolly Pine Blvd.  
Fairview, TN 37062



## **Hydroflo Mechanical Seal Installation**

### **IMPORTANT TO FOLLOW THE FOLLOWING PROCEDURE**

#### **Standard Cartridge Seal Construction**

- 316SS Housing
- Balanced Seal
- Multi-Spring
- Tungsten Carbide Faces
- Viton Elastomers
- Rated up to 300 PSI working pressure

*The pumps should be installed and started by a professional installer and a licensed electrician.*

**[WWW.HYDROFLOPUMPS.COM](http://WWW.HYDROFLOPUMPS.COM)**

**Hydroflo Pumps USA, Inc.**

7118 Loblolly Pine Blvd.

Fairview, TN. , 37062



A **TACO** COMPANY

MECHANICAL SEAL

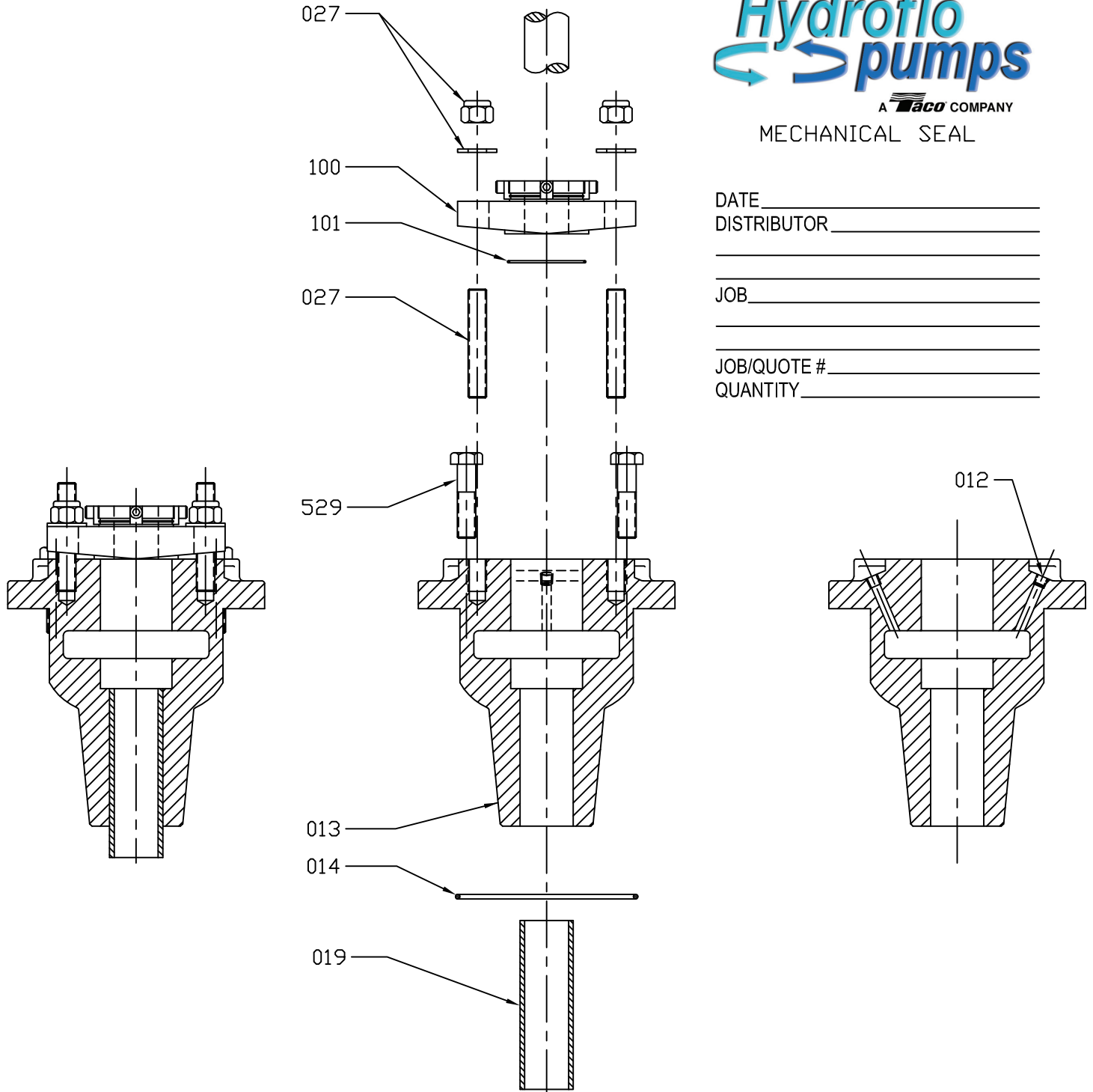

DATE \_\_\_\_\_  
 DISTRIBUTOR \_\_\_\_\_  
 \_\_\_\_\_  
 JOB \_\_\_\_\_  
 \_\_\_\_\_  
 JOB/QUOTE # \_\_\_\_\_  
 QUANTITY \_\_\_\_\_

CATALOG NUMBER	QTY.	PART NAME	STANDARD MATERIAL (A.S.T.M. DESIGNATION)	SPECIFICATION REQUIREMENT
012	2	NPT PIPE PLUG	COMMERCIAL	
013	1	DUCTILE IRON PACKING BOX	A-536 GR. 65-45-12	
014	1	O-RING, PACKING BOX	BUNA 70-DURO	
019	1	BEARING, PACKING BOX	BRONZE B-505-932	
529	4	SCREW, CAP	COMMERCIAL	
027	2	STUD, FLAT WASHER, AND NUT	STAINLESS STEEL	
100	1	BALANCED, MULTI-SPRING SEAL	316SS HOUSING, TUNGSTEN CARBIDE FACES, VITON ELASTOMER	
101	1	O-RING, SEAL	VITON	

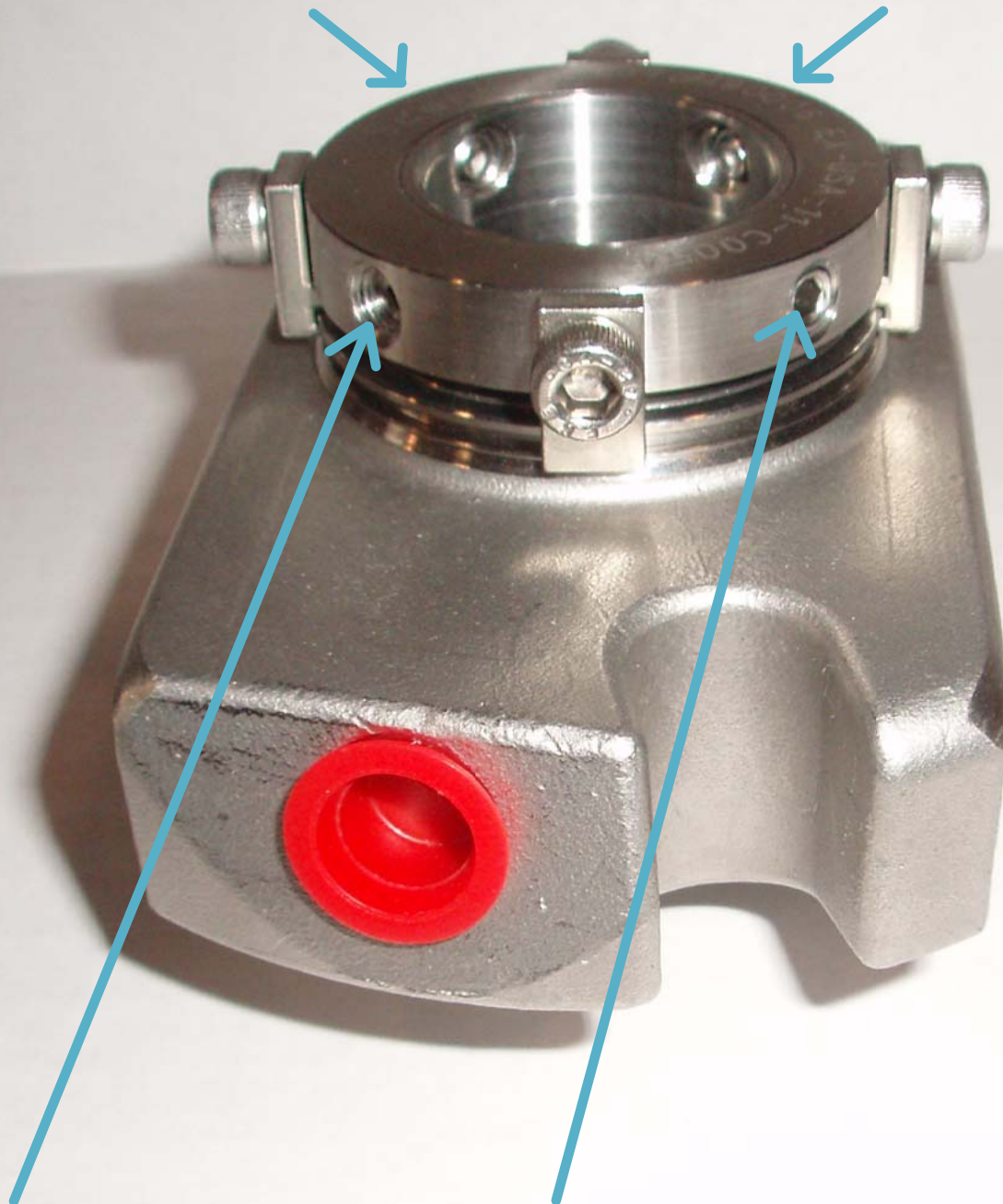

1. SECURE the seal into the stuffing box of the discharge head.
2. Set the lateral (impellers) of the pumps adjusting the head shaft or flanged motor coupling.
3. Tighten indicated 4 set screws to the pump shaft.

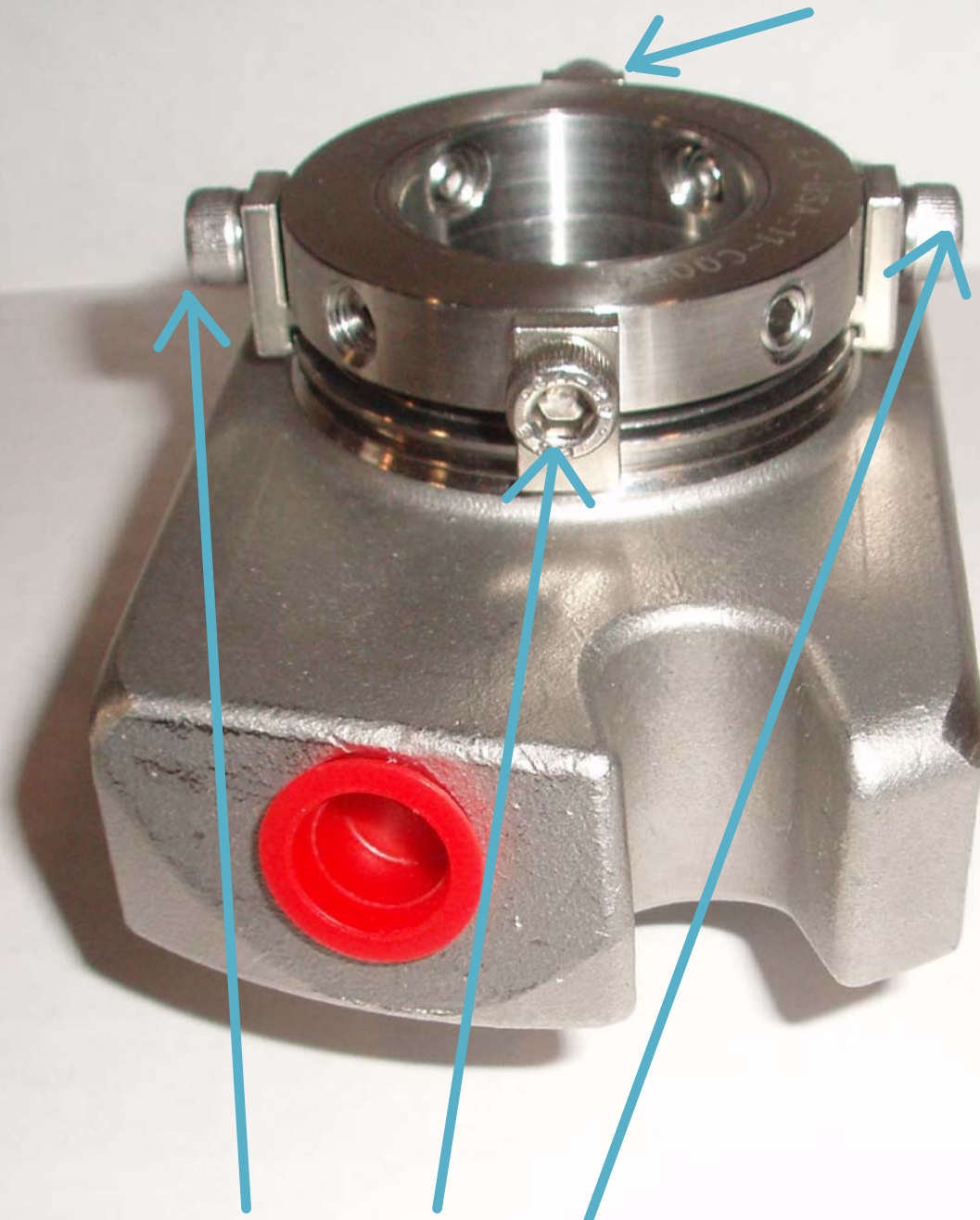

4. Remove these 4 set screws and 4 seal blocks from the mechanical seal.

THE SEAL IS NOW SET TO THE SHAFT  
IN THE CORRECT POSITION FOR OPERATION



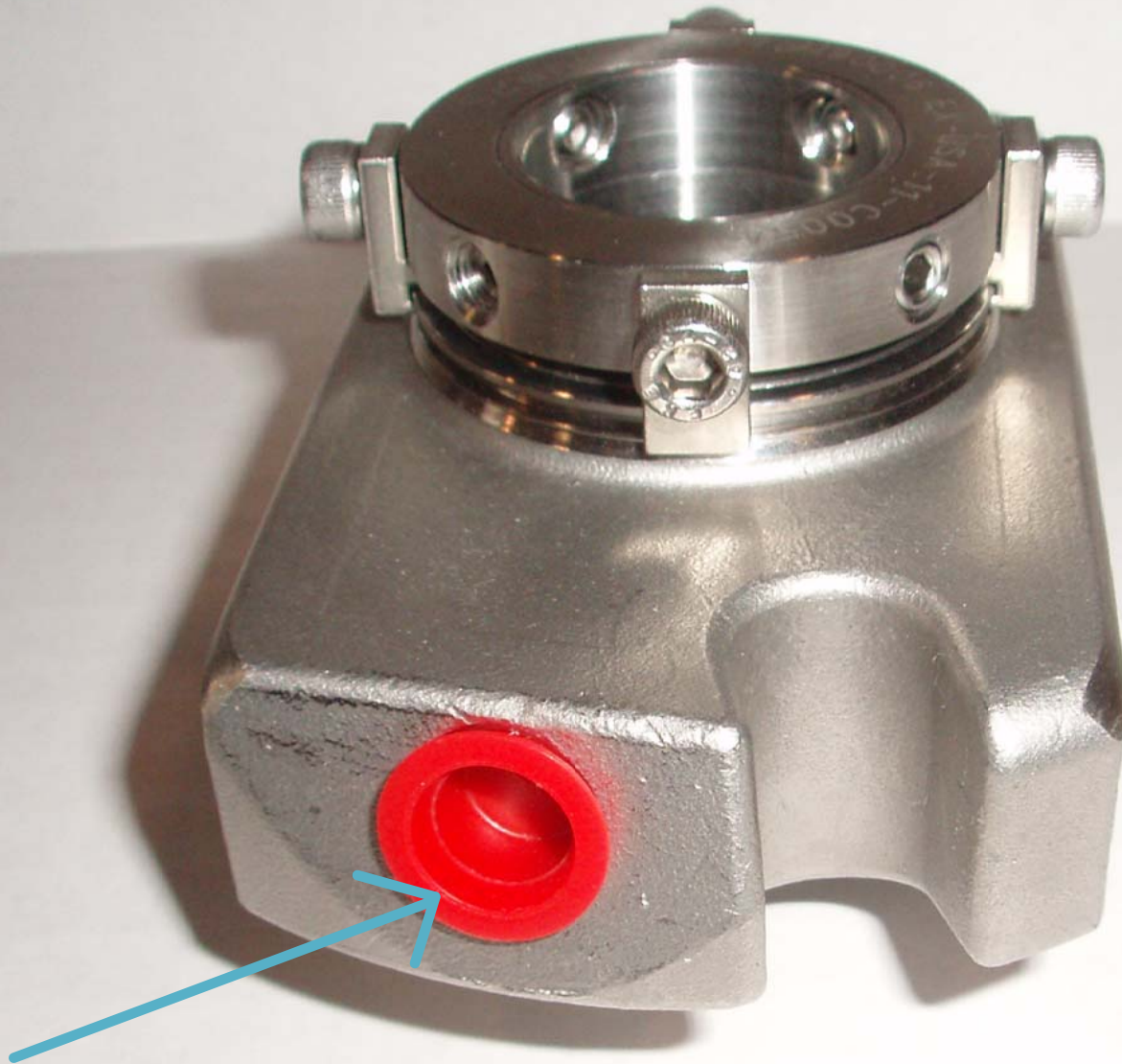

5. Before operation, you **MUST** connect a vent line to the seal. You will find two red caps in the seal at 180 degrees. The small cap is the vent side. You must run a vent line from this port. The large cap is the flush port, you can plug the flush port with the stainless steel plug provided. However, you can run a fresh water flush line to this port if available.
6. The seal is now ready and you can bump the pump to check proper rotation. Once rotation is checked, you are ready to start the pump.